



## Wallace & Tiernan<sup>®</sup> Gas Feed Systems

### Low Capacity Gas Pressure Reducing Valve

The Gas Pressure Reducing Valve is an independent, heavy-duty spring loaded diaphragm valve, providing an automatically regulated output and a positive manual shut off. Its maximum capacity is 4g/s for chlorine and slightly less for sulphur dioxide.

This compact device is available with an optional trap and filter to separate impurities, and an optional bracket for wall-mounting applications.

Chlorine gas from cylinders or drums is reduced in pressure to the optimum for chlorinator operation. Mounted close to the source of supply, the valve minimises the possibility of reliquefaction of the gas in the pipeline, so reducing plant-room heating requirements. A range of accessories, available to order, increases installation versatility.

#### FEATURES

- Simple installation - mounted directly in the gas supply line or wall mounted using the optional bracket, when flexible connections can be employed if desired.
- Automatic regulation of output pressure-no adjustment is required.
- Positive manual gas shut-off by single on/off knob
- Safe, reliable operation ensured by rugged construction and adequate use of corrosion resistant alloys and plastics.
- Contaminants removed - optional trap and filter unit protects chlorination systems by allowing impurities to settle out or be removed by replaceable filter.

#### DESIGN & CONTROL

The valve consists of a body, bonnet, diaphragm, seat, stem, cone, guide, spring and in/off knob. The combination of a resilient seat and hard stem and cone gives a tight shut-off, and the guide ensures accurate seating. The diaphragm has good flexibility and is leakproof. As the supply pressure increases and overcomes the force of the spring the diaphragm moves, pushing the stem and cone closer to the seat, throttling the supply until its pressure balances the compression of the spring. Pre-set spring pressure gives correct, regulated output and no adjustment is necessary. The trap and filter unit is optional but is recommended for use where withdrawal rates exceed 260mg/s. Dismantling the valve and cleaning the component parts are simple operations. The renewable filter is easy to replace.

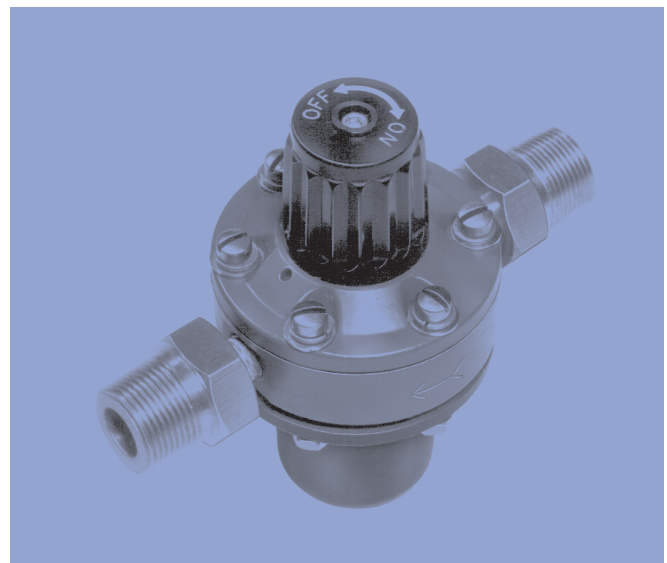

## TECHNICAL INFORMATION

Flow Rate:	0-4g/s chlorine, 0-3.5g/s sulphur dioxide.
Pressure reduction:	From full cylinder pressure to a nominal 1.5bar gauge.
Materials in contact	Forged brass body; ptfе seat, with gas: tungsten stem, tantalum cone, ptfе diaphragm, brass diaphragm cap nut, Monel stem guide, chemical lead gaskets.
Diaphragm:	Made of ptfе, backed by Hypalon® and a segmented disc of beryllium-copper.
Trap and filter unit: Trap:	Forged brass. Replaceable filter: ptfе (U28557B only).
Mounting:	Standard valve is fitted with adaptor having an R3/4 thread. When cylinder or drum flexible connectors are supplied the valve will be fitted with appropriate adapters if requested. Mounted direct in supply piping, or wall mounted by means of bracket having two 10mm holes at 63.5mm centres. Bracket (32319D) supplied if requested.
Optional accessories:	Trap and filter unit, manifolds, spanners, pressure gauges, flexible connections and fittings.
Shipping weight:	Wall mounted 2.0kg. Wall mounted with trap and filter, 2.7kg.
Dimensions:	See diagrams.

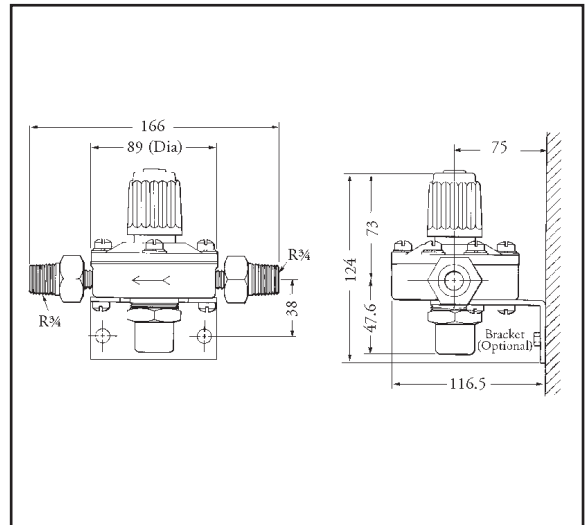

Without trap and filter (U28556B)

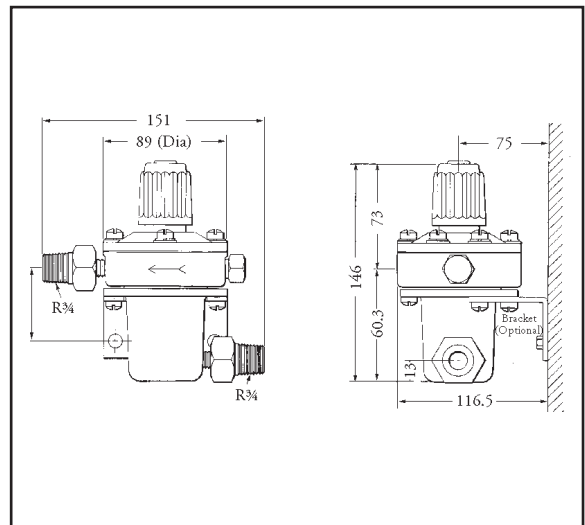

With trap and filter (U28557B)